

**STORMWATER NOTE:**  
 STORMWATER AS PER HYDRAULICS ENGINEER'S  
 PLANS AND BASIX REQUIREMENTS ALL IN  
 ACCORDANCE WITH AUSTRALIAN STANDARD 3500.3

**CALCULATIONS**

Calculated Total Site Area : 461.20m<sup>2</sup>

**FLOOR SPACE**

FSR allowed : 230.60m<sup>2</sup> / 50%  
 Existing FSR remains 142.20m<sup>2</sup> (Proposed Carport Only)  
 (COMPLIES NUMERICALLY)

**PRIVATE OPEN SPACE**

Existing : 163.75m<sup>2</sup>

**CARPARKING PROPOSED**

Dwelling : 1 SPACE

**LANDSCAPING (34.60%)**

Dwelling : 164.40m<sup>2</sup>

**SITE COVERAGE**

- BUILDING FOOTPRINT MAX. 330.0m<sup>2</sup> - Actual 159.70m<sup>2</sup>  
 - Carport, Patio, Portch and Pool are Excluded  
 Total all structures 159.70m<sup>2</sup> (34.62%)

SHAW AVENUE

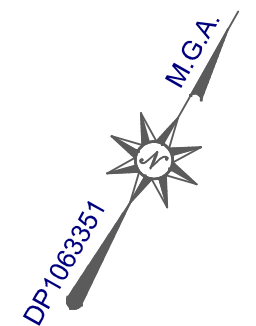
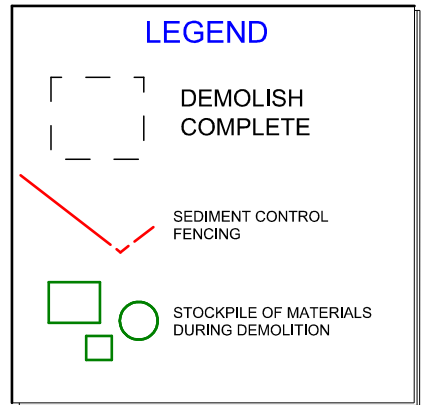
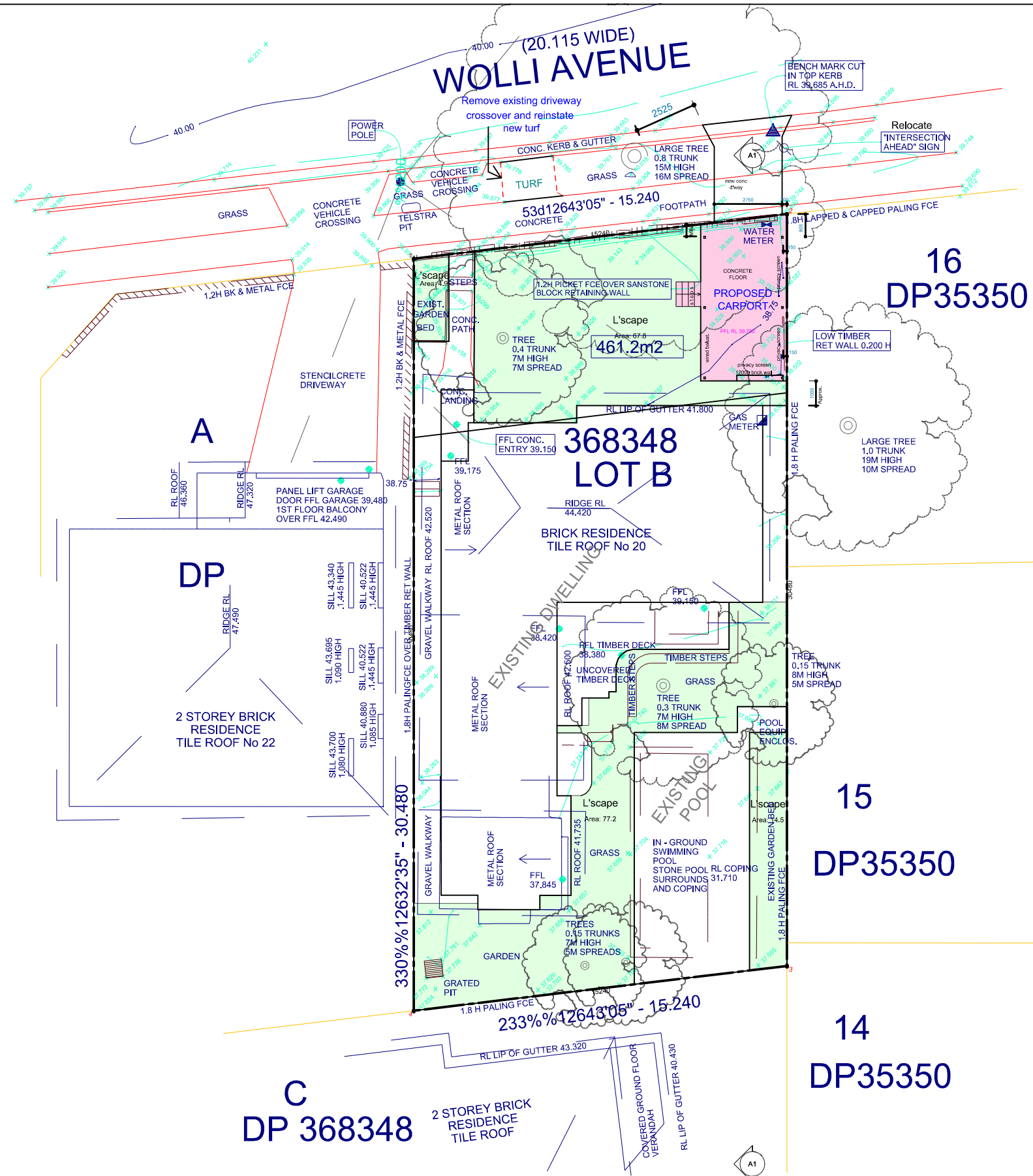

**dbb design - basix - build**

M: 0417 45 888 6  
 E: design@d-b-b.com  
 W: d-b-b.com

**bdca ACCREDITED BUILDING DESIGNER**

experienced & practising designer & builder Since 1997

**Not FOR CONSTRUCTION**

Client : Mr & Mrs Meylakh

Project Title : Proposed Carport at:  
**Lot B, 20 Wolli Avenue, Earwood**

E		
D		
C		
B		
A	17/05/24	DA SUBMISSION
No.	Date	Revision

Note:  
 -Do not scale off drawings  
 -All works to be setout by a registered survey  
 -Builder or contractor to verify all dimensions & levels as well notify the designer of any discrepancies prior to commencing any work  
 -Refer to Engineers drawings for structural details  
 © Copyright of design and information shown here is retained and authority is required for any reproduction.  
 -Not for Construction unless noted otherwise in the issue and revision block

**PROPOSED SITE PLAN**

Scale: <b>1:200</b>	Drawn By: <b>dbb</b>	Drawing No. <b>02</b>
Date: <b>20/02/24</b>	Issue: <b>DA-A</b>	